

**GARDE-CORPS SECURIGARD - DEMANDE DE PRIX**

A nous retourner par fax au 02 33 84 21 14 au Service Administration des ventes

**ENVOYER PAR MAIL**

N'oubliez pas de joindre un plan

**02 IM 13**

03/2017

Page 1/2

**VOUS**
[Réinitialiser le formulaire](#)

Société : ..... Contact : .....  
 Adresse : .....  
 Code Postal : ..... Ville : .....  
 Téléphone : ..... Fax : .....  
 Email : .....



**CHANTIER**

Nom : ..... Contact : .....  
 Adresse : ..... Téléphone : .....

Nature du projet  Neuf  Rénovation Phase du projet  Etude  Affaire

**POTELETS**

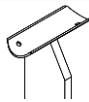
MAIN COURANTE  1000 mm /  1100 mm TEINTE RAL .....

MATIERE	<input type="checkbox"/> ACIER	<input type="checkbox"/> ALUMINIUM	<input type="checkbox"/> ALUMINIUM RABATTABLE
<b>TYPE DE POTELET</b>	<input type="checkbox"/> Tube oblong (OVALIC / STABILIC) 	<input type="checkbox"/> Fer plat 60x10mm (GC60) 	<input type="checkbox"/> Tube oblong (OVALIC / STABILIC) 
<b>FORME DE POTELET</b>	<input type="checkbox"/> Droit <input type="checkbox"/> Incliné <input type="checkbox"/> Cintré	Droit	<input type="checkbox"/> Droit <input type="checkbox"/> Incliné <input type="checkbox"/> Cintré
<b>FIXATIONS</b> <b>!</b> Schémas des fixations en page 2 de ce document	<input type="checkbox"/> Autoportant <input type="checkbox"/> Z150 <input type="checkbox"/> Z250 <input type="checkbox"/> Z250 avec cale <input type="checkbox"/> Applique <input type="checkbox"/> Platine <input type="checkbox"/> Embase à étancher	<input type="checkbox"/> Attente applique <input type="checkbox"/> Platine	<input type="checkbox"/> Autoportant <input type="checkbox"/> Z150 Alu <input type="checkbox"/> Z250 Alu <input type="checkbox"/> Applique Alu <input type="checkbox"/> Z150 Acier <input type="checkbox"/> Z250 Acier <input type="checkbox"/> Z250 Acier avec cale <input type="checkbox"/> Applique Acier <input type="checkbox"/> Platine Acier <input type="checkbox"/> Embase Acier à étancher <input type="checkbox"/> Toiture Bac sec <input type="checkbox"/> Toiture Bac isolé
			<input type="checkbox"/> Autoportant <input type="checkbox"/> Z150 <input type="checkbox"/> Z250 <input type="checkbox"/> Applique <input type="checkbox"/> Platine Fixations en acier

**INFORMATIONS COMPLEMENTAIRES**

Indiquez la quantité de potelets si le calepinage est déjà connu : .....

Terrasse Nombre de ml : ..... ml

Nombre d'angles 90° : ..... Variables : .....

Acrotère Présence acrotère :  oui  Non Matière :  Acier  Béton

Hauteur minimale (H) : ..... mm Largeur (L) : ..... mm

Surface acrotère :  Plate  Pente  Autres : .....

Isolation sol :  oui  non Epaisseur : ..... mm

Relevé isolé :  oui  non Epaisseur : ..... mm

Acrotère isolé :  oui  non Epaisseur (A) : ..... mm

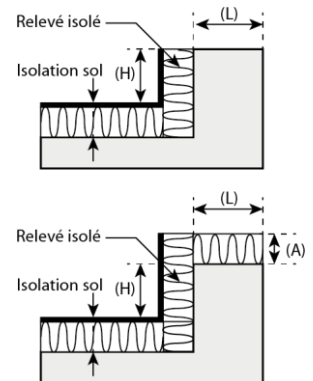

**ENVOYER PAR MAIL**

N'oubliez pas de joindre un plan

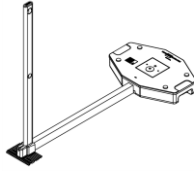

## GARDE-CORPS AUTOPORTANTS

Autoportant Aluminium ▼



Autoportant Acier ▼

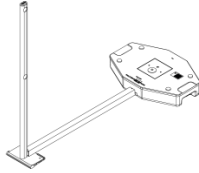

## GARDE-CORPS FIXES / FIXATIONS ACIER

Z150 ▼

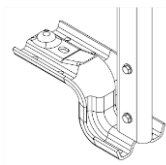

Z250 ▼

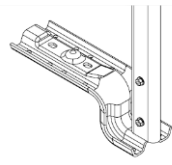

Z250 avec cale ▼

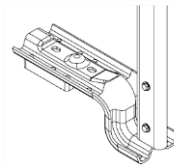

Applique ▼

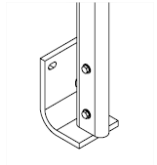

Platine ▼

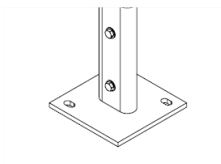

Embase à étancher ▼

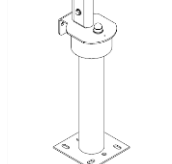

Toiture bac sec ▼

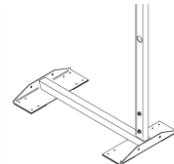

Toiture bac isolé ▼

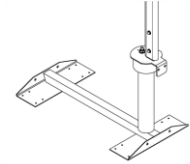

Attente applique GC60 ▼

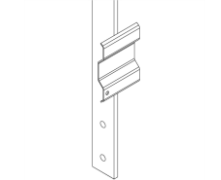

Platine GC60 ▼

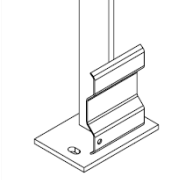

## GARDE-CORPS FIXES / FIXATIONS ALUMINIUM

Z150 ▼

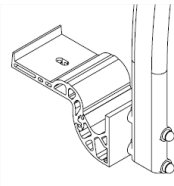

Z250 ▼

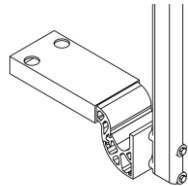

Applique ▼

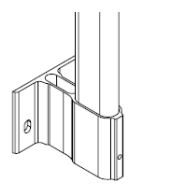

## GARDE-CORPS RABBATTABLES ALUMINIUM

Autoportant ▼



Z150 ▼

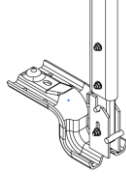

Z250 ▼

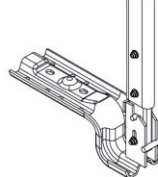

Applique ▼

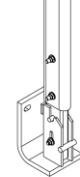

Platine ▼

